

view A

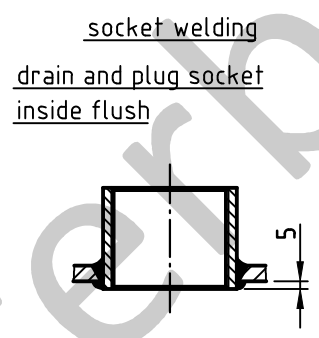
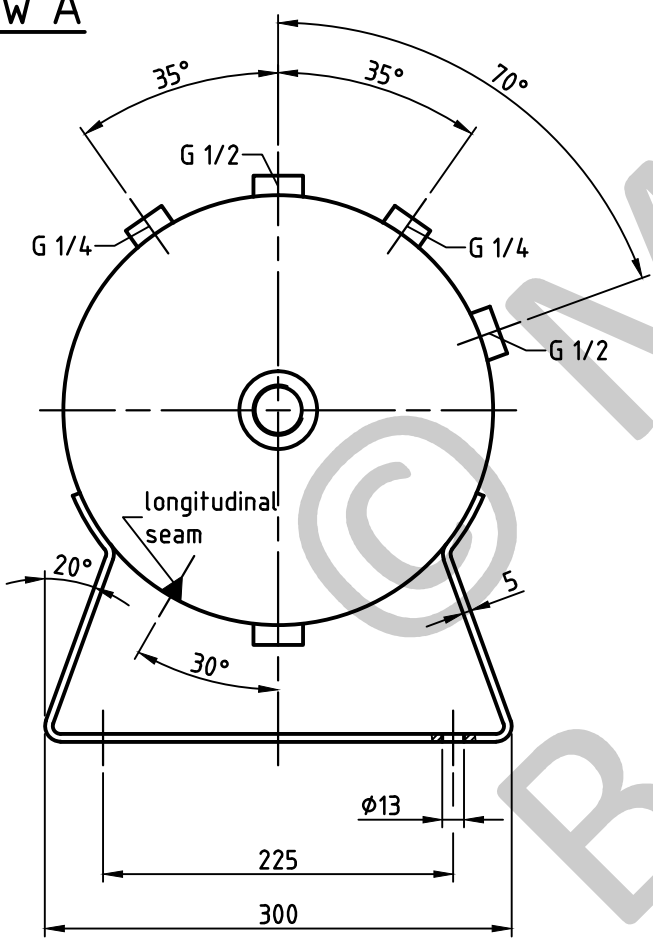

SEAMS (unless otherwise indicated on drawing):		
longitudinal seam 	socket-/flangeweldings 	circumferential seams beadseams only up to 8mm wall thickness of bottoms cyl. brim > 3,5 x wall thickness of bottoms
pressure variation :		
pressure swing 0-16 bar max. operations 1.000		
infinite operation of pressure swing within 20% of 16 bar		
operational characteristics / calculation characteristics :		
volume V (litre)	: 1000	
max. working pressure PS (bar)	: 16	
test pressure PT (bar)	: 22,88	
min. working temp. TS (°C)	: -10	
max. working temp. TS (°C)	: 50	
fluid	: compressed air/nitrogen (fluid group 2)	
location	: inside and outside building possible	
coating :		
inside : raw	or: inside : hot dip galvanized	
outside : primed (if customer wishes lacquered)	outside : hot dip galvanized	
manufacturing and testing		
acc. to PED 2014 / 68 / EU - AD 2000		
conformity benchmark :		
fluid group : 2	category : II	
diagram : 2	module : B + C1 / H	

scale :	1:5
our no. :	-
order no. :	-
used for :	M+B Standardvessel
weight :	ca.25 kg
sheet :	1
of sheet :	1
date of plot :	24.06.2015
file :	ENG-010819

Maschinen- und Behälterbau GmbH

	date	name
compl.	24.06.2015	CW
appr.	24.06.2015	Nota 2

follow protection mark acc. to DIN 34

Betzdorfer Str. 170
57567 Daaden
Tel. 02743/9330-12
Fax 02743/3685
Internet: www.mabe.de
E-Mail: cad@mabe.de

description :	
pressure vessel horizontal 50 l 16 bar	
drawing no. :	revision : A
MB 030602-2.50/E	
drawing no. of design inspection :	date of revision : 24.06.2015
MB 030602-2.50	revision only on CAD